



Manufactured to meet or exceed original equipment specifications.

Photos Actual Size

## Door Panel Grommet with Sealer

- Chrysler 200 2015-2017, 300 2011+
- Dodge Challenger 2015 - 2016 and 2022, Charger 2011+, Durango 2015, Viper 2017
- Jeep Cherokee 2015, Grand Cherokee 2021+, Wrangler 2014 - 2018
- Chrysler OEM No. 68138992-AA
- 22mm Head Dia.
- 13mm Stem Length
- 16mm Overall Height
- Fits into 9mm Hole
- White Nylon

| Item No. | Pkg. Qty. |
|----------|-----------|
| 1637358  | 25        |



## Door Trim Panel Retainer with Sealer

- Jeep Grand Cherokee 2021+, Grand Wagoneer and Wagoneer 2022+
- Chrysler OEM No. 6513137AA
- 12mm Top Head Dia.
- 16mm Bottom Head Dia.
- 8.75mm Stem Dia.
- 18mm Stem Length
- 26.7mm Overall Length
- White Nylon

| Item No. | Pkg. Qty. |
|----------|-----------|
| 1639069  | 25        |



## Window Moulding Retainer

- Ford Escape 2013-2019, Fiesta 2011-2019, Focus 2012-2018
- Ford OEM No. W709011-S300
- 10mm Top Head Dia.
- 14mm Bottom Head Dia.
- 5.5mm Stem Dia.
- 8mm Stem Length
- 13mm Overall Length
- White Nylon

| Item No. | Pkg. Qty. |
|----------|-----------|
| 1639080  | 25        |



## Rear Door Crew Cab Weatherstrip Retainer

- Ford F-150 2019+
- Not Available from OEM
- 4mm x 15mm Head Size
- 9.5mm Stem Length
- Fits into 4mm Hole
- 1.25mm-2.75mm Panel Range
- 10.5mm Overall Height
- Black Nylon

| Item No. | Pkg. Qty. |
|----------|-----------|
| 1639070  | 50        |



## Fender Apron Torx® Drive Tapping Screw with Sems® Washer

- Buick Enclave 2018+, Encore 2020+, Envision 2016+, LaCrosse 2017-2019, Regal 2018-2020
- Cadillac ATS, CTS 2015-2019, CT4, CT5 2020+, CT6 2016-2020, Escalade 2021+, XT4 2019+, XT5 2017+, XT6 2018+
- Chevrolet Blazer 2019+, Bolt 2017+, Camaro, Malibu 2016+, Caprice 2014-2017, Colorado, Corvette 2015+, Cruze, Equinox 2018+, Impala 2015-2020, Silverado 1500 2019-2021, Silverado 2500 HD, 3500 HD 2020+, SS 2016-2017, Suburban, Tahoe, Trailblazer 2021+, Volt 2016-2019
- GMC Acadia 2017+, Canyon 2015+, Sierra 1500 2019 - 2021, Sierra 2500HD, 3500HD 2020+, Terrain 2016+, Yukon 2021+
- GM OEM No. 11548270
- M4.2-1.41 x 20mm
- 19.5mm Conical Washer Dia.
- T-15 Torx® Drive
- 'BR' Point
- Trivalent Black Zinc

| Item No. | Pkg. Qty. |
|----------|-----------|
| 1639062  | 25        |



## Hood Cable Clip

- Buick Encore 2013-2022
- Chevrolet Bolt EV 2017-2021, Cruze 2011-2016, Sonic 2012-2020, Spark 2016-2022, Trax 2015-2022
- GM OEM No. 94530268
- Holds 5mm Cable
- 10mm x 12mm Head Size
- 22mm Flange Dia.
- 12mm Stem Length
- 24mm Overall Height:
- Fits into 8mm Hole
- Black Nylon

| Item No. | Pkg. Qty. |
|----------|-----------|
| 1639075  | 25        |



## Door Window Trim Retainer

- Buick Regal 2011-2017
- Chevrolet Caprice 2011-2017, Chevelle SS 2014-2017
- Pontiac G8 2008-2009, GTO 2004-2006
- GM OEM No. 90459628
- 10mm Top Head Dia.
- 10mm Middle Head Dia.
- 12mm Bottom Head Dia.
- 5.6mm x 7.3mm Stem Dia.
- 11.5mm Stem Length
- 17mm Overall Length
- White Nylon

| Item No. | Pkg. Qty. |
|----------|-----------|
| 1639074  | 25        |





Manufactured to meet or exceed original equipment specifications.

Photos Actual Size

### Exterior Moulding Clip with Sealer

- Bronco Sport 2021+, Escape 2020+, Maverick 2022+
- Lincoln Corsair 2020+
- Ford OEM No. W719971-S300
- 12mm x 16mm Top Head Dia.
- 12mm x 16mm Bottom Head Dia.
- 8mm x 18mm Stem Dia.
- 14mm Stem Length
- 19mm Overall Length
- Fits into 9mm Hole
- White Nylon



| Item No. | Pkg. Qty. |
|----------|-----------|
| 1639071  | 25        |

### Body Panel Specialty Rivet

- Tesla 3 2017+, S and X 2016+, Y 2020+
- Tesla OEM No. 1028408-00-A
- 1/4" Dia.
- 5/64"-3/8" Grip Range
- 1/2" Flange Dia.
- Steel Rivet and Mandrel



| Item No. | Pkg. Qty. |
|----------|-----------|
| 1639082  | 25        |

### Rocker Moulding Retainer with Sealer

- Genesis GV70 2022, GV80 2021-2022
- Hyundai Ioniq 2017-2022, Kona 2018-2022, Santa Fe 2019-2020, Palisade, Sonata 2020-On
- Kia K5 2021+, Telluride 2020+
- Hyundai OEM Nos. 87758-G2000, 87767-J9000
- 6mm x 18mm Top Head Size
- 18mm x 32mm Bottom Head Size
- 9mm x 13.5mm Stem Size
- 10mm Stem Length
- 16mm Overall Length
- White Nylon



| Item No. | Pkg. Qty. |
|----------|-----------|
| 1637343  | 15        |

### Exterior Trunk Trim Snap-In Nut

- Hyundai Elantra 2021+
- Hyundai OEM No. 87382-AA000
- M6-1.0 Screw Size
- 13.5mm x 18mm Head Size
- 13mm Stem Length
- Fits into 12mm x 13.5mm Slot
- 2.5-3.0mm Panel Range
- Silver Geomet Finish

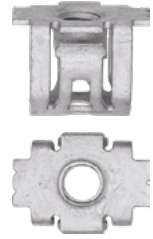

| Item No. | Pkg. Qty. |
|----------|-----------|
| 1637359  | 10        |

### Fender Apron Push-Type Retainer

- Mitsubishi Eclipse 2005-2012, Eclipse Cross 2018-2020, Endeavor 2005-2011, Galant 2004-2012, Lancer 2002-2017, Mirage 2014-2017, Outlander 2003-2022
- Mitsubishi OEM No. MU488006
- 20mm Head Dia.
- 11mm Stem Length
- 7.8mm Stem Dia.
- Fit into 8mm Hole
- 3.5-5mm Panel Range
- Black Nylon



| Item No. | Pkg. Qty. |
|----------|-----------|
| 1639052  | 25        |

### Wheel Flare Moulding Grommet with Sealer

- Infiniti EX35 2008-2012, EX37, FX35 2009-2012, FX37 2013, FX50 2009-2013, QX50, QX80 2014-2020, QX56 2011-2013, QX70 2014-2017
- Nissan Armada 2017-2021, Kicks, Titan 2018-2021, Juke 2011-2017, Murano 2015-2021, Pathfinder 2019-2020, Rogue 2014-2021
- Infiniti and Nissan OEM No. 76848-JG00B
- 12mm x 16mm Head Size
- 10mm Stem Length
- 12mm Overall Height
- Clear Nylon



| Item No. | Pkg. Qty. |
|----------|-----------|
| 1639078  | 10        |

### Wheel Opening Moulding Clip

- Nissan Armada 2017+, Juke 2011-2017, Rogue 2014-2017
- Nissan OEM No. 76882-JG00A
- 6mm x 12mm Top Head Size
- 16mm Bottom Head Dia.
- 10mm Stem Length
- White Nylon



| Item No. | Pkg. Qty. |
|----------|-----------|
| 1639079  | 25        |



Manufactured to meet or exceed original equipment specifications.

Photos Actual Size

## Bumper Bracket #2 Phillips Pan Head Tapping Screw

- Audi A4 1996-2001, A6 1998-2004, S4 2000-2002, S6 2002-2003, V8 Quattro 1990-1994
- Audi OEM No. N-013-969-21
- M4.8-1.61 x 15mm
- 'B' Point
- Black Zinc

| Item No. | Pkg. Qty. |
|----------|-----------|
| 1639060  | 25        |



## Radiator Grille Torx® Round Washer Head Tapping Screw

- Audi A3 2015-2016, S3 2015-2016, S8 2015-2018, TT 2018-2020
- Audi OEM No. WHT-006-726
- M5-2.12 x 12mm
- 12mm Washer Dia.
- T-25 Torx® Drive
- Black Zinc

| Item No. | Pkg. Qty. |
|----------|-----------|
| 1639068  | 25        |



## Wheel Apron Thumb Drive Nut

- Lexus ES300 2002-2003, ES330 2004-2006, GX470 2003-2009
- Toyota Camry 2007-2011, 4Runner 2003-2009
- Lexus and Toyota OEM No. 90467-06169
- M6-1.0 Thread Size
- 18mm Flange Overall Dia.
- 10mm Height
- Black Nylon

| Item No. | Pkg. Qty. |
|----------|-----------|
| 1639076  | 25        |



## Lifgate and Quarter Trim Panel Clip

- Lexus CT200h 2011-2017, ES300h, ES350 2013-2018, GS F 2016-2020, GX460 2010-2021, HS250h 2010-2012, LS460 2009-2017, LS600hL 2009-2016, LX570 2008-2021, RC F 2015-2020, RX350, RX450h 2010-2015
- Scion iQ 2012-2015
- Toyota 4Runner 2010-2021, Corolla 2009-2019, FJ Cruiser 2012-2014, Highlander 2012-2019, Land Cruiser 2008-2021, Matrix 2009-2014, Prius 2010-2019, RAV4 2013-2014, Sienna 2010-2011, Yaris 2012-2018
- Lexus and Toyota OEM No. 63395-12150
- 13mm Top Head Dia.
- 16mm Middle Head Dia.
- 18mm Bottom Head Dia.
- 8.5mm Stem Dia.
- 11mm Stem Length
- 16.5mm Overall Length
- Fits into 8.5mm Hole
- Black and White Nylon

| Item No. | Pkg. Qty. |
|----------|-----------|
| 1639054  | 25        |



## Fog Lamp Phillips Round Washer Head Thread Cutting Tapping Screw

- Lexus CT200h 2011-2017, ES250 2021, ES300h, ES350 2013-2021, GS F, RC300 2016-2020, GS Turbo, RS Turbo 2017, GS200t 2016, GS300 2018-2019, GS350 2013-2020, GS450h 2013-2018, GX460 2010-2021, HS250h 2010-2012, IS F 2008-2014, IS200t, RC200t 2016-2017, IS250 2012-2015, IS300 2016-2021, IS350 2012-2021, LC500, LC500h, LS500, LS500h, NX300, RX350L, RX450hL, UX200, UX250h 2018-2021, LS460 2013-2017, LS600hL 2013-2016, LX570 2008-2021, NX200t 2015-2017, NX300h, RC F, RC350 2015-2021, RX350, RX450h 2010-2022
- Scion iM 2016, iQ 2012-2015, tC 2011-2016
- Toyota 4Runner 2010-2022, Avalon, Tundra 2013-2021, Camry, RAV4 2012-2021, CHR, 2014-2022, Highlander 2014-2021, Land Cruiser 2015-2021, Matrix 2009-2014, Mirai 2022-2016, Prius 2021-2010, Sequoia 2021-2017, Sienna 2022-2011, Tacoma 2011-2021, Venza 2009-2021, Yaris 2007-2018
- Lexus and Toyota OEM No. 90167-50063
- M5-1.81 x 13mm
- 11mm Washer Dia.
- Zinc

| Item No. | Pkg. Qty. |
|----------|-----------|
| 1639053  | 25        |



## Side Panel Retainer with Sealer

- Toyota Highlander 2020-2021, RAV4 2019-2021, Venza 2021
- Toyota OEM No. 76828-60030
- 19mm x 23mm Oval Head Dia.
- 13mm x 17mm Oval Stem Dia.
- 13mm Stem Length
- Fit into 13.5mm x 17mm Oval Hole
- 1mm Panel Range
- White Nylon

| Item No. | Pkg. Qty. |
|----------|-----------|
| 1639055  | 25        |

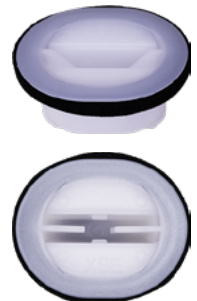

## Stop Lamp Housing Retainer with Sealer

- Lexus ES300 2002-2003, ES330 2004-2006, ES350 2007-2012, LX570 2008-2021
- Scion iM 2016
- Toyota Highlander Avalon 2005-2012, Corolla iM 2017-2018, Land Cruiser 2008-2021, Prius 2010-2012
- Lexus and Toyota OEM No. 81496-28010
- 13mm Head Dia.
- 18mm Bottom Head Dia.
- 8.5mm Stem Dia.
- 11mm Stem Length
- 16mm Overall Length
- White Nylon

| Item No. | Pkg. Qty. |
|----------|-----------|
| 1639056  | 25        |





# LAND ROVER/VOLKSWAGEN/AUDI



Manufactured to meet or exceed original equipment specifications.

Photos Actual Size

## Hood Release Cable Clip

- Land Rover Discovery 2017+, Range Rover 2014-2022
- Land Rover OEM No. LR013332
- Holds 5mm cable
- 12mm x 22mm Flange Size
- 11mm Stem Length
- 23mm Overall Height
- Fits into 7mm Hole
- Black Nylon

| Item No. | Pkg. Qty. |
|----------|-----------|
| 1639050  | 25        |



## Fender Liner Self-Threading Flange Nut

- Land Rover Discovery 2015+, Range Rover 2012+
- Land Rover OEM No. RYH500780
- Fits M6 Stud Size
- 16mm Flange Overall Dia.
- 10mm Hex Size
- 10mm Height
- Black Nylon

| Item No. | Pkg. Qty. |
|----------|-----------|
| 1639051  | 25        |



## Rocker Moulding Push-Type Retainer

- Land Rover Defender 90 2021+, Defender 110 2020+, Discovery 2017+, LR3 2005-2009, LR4 2010-2016, Range Rover 2006-2022
- Land Rover OEM No. HYQ100060PUY
- 19mm Head Dia.
- 22mm Stem Length
- 7mm Stem Dia.
- Fits into 7mm Hole
- 5-13mm Panel Range
- Black Nylon

| Item No. | Pkg. Qty. |
|----------|-----------|
| 1639049  | 25        |



## General Purpose Posi-Phillips Truss Washer Head Tapping Screw

- Land Rover Discovery 3 2005-2009, 4 2010-2016
- Land Rover OEM No. CYP100800
- M4.8-1.61 x 19mm
- #2 Posi-Phillips Drive
- 19mm Length
- 11mm Washer Dia.
- #2 Posi-Phillips Drive
- Black Zinc

| Item No. | Pkg. Qty. |
|----------|-----------|
| 1639048  | 25        |



## Bumper Cover Torx®/Slotted Flat Round Washer Head Tapping Screw

- Audi Q7 2012-2020, Q8 2019-2020, SQ7, SQ8 2020
- VW Arteon, Jetta 2019-2021, Atlas 2020-2022, Beetle 2012-2019, CC 2013-2017, Eos 2012-2016, ID.4 2021-2022, Passat 2016-2021, Touareg 2011-2017
- Audi and VW OEM No. WHT-003-954
- M5-2.12 x 16mm
- 14mm Washer Dia.
- T-25 Torx® Drive
- Dog Point Type
- Black Zinc

| Item No. | Pkg. Qty. |
|----------|-----------|
| 1639067  | 25        |



## Headlamp and Radiator Support Torx® Button Head Screw with Sems Washer

- Audi A4, Q7 2017-2020, A5, Q5, SQ5 2018-2020, A8 Quattro, S8, SQ7, SQ8 2020, e-tron Quattro, Q8 2019-2020, TT, TTS Quattro 2016-2020, Arteon, Jetta 2019-2021
- VW Atlas, Tiguan 2018-2022, Beetle, 2012-2019, CC 2013-2017, e-Golf 2015-2019, Golf, GTI 2015-2021, ID.4 2021-2022, Passat 2012-2021, Touareg 2011-2014
- Audi and VW OEM No. N-909-936-03
- M6-1.0 x 25mm
- 8.8 Class
- 20mm Washer Outer Dia.
- T-30 Torx® Drive
- Round Dog Point Type
- Black Zinc

| Item No. | Pkg. Qty. |
|----------|-----------|
| 1639065  | 25        |



## Fender Apron U-Nut

- Audi A3 2006-2020, A4 2017-2020, A5 Quattro, Q3, S4, S5, SQ5 2018-2020, A6, A7 Quattro 2012-2020, A8 Quattro, e-tron Quattro 2019-2020, RS5 2013-2015, RS5 Sportback 2019, RS7 2014-2018, S3 2015-2020, S6, S7 2013-2020, S8 2020, TT, TTS Quattro 2016-2020
- VW Arteon 2019-2022, Beetle 2012-2019, CC 2009-2017, e-Golf 2015-2019, Eos 2007-2016, Golf 2010-2021, GTI, Passat 2006-2021, ID.4 2021-2022, Jetta 2005-2021, Phaeton 2004-2006, R32 2008, Rabbit 2006-2009, Tiguan 2009-2022, Touareg 2011-2017
- Audi and VW OEM No. N-909-591-01
- M4.2-1.41 (#8) Screw Size
- 2.5mm Panel Range
- 8.5mm Center of Hole To Edge
- 11mm Width
- 16.5mm Length
- Zinc

| Item No. | Pkg. Qty. |
|----------|-----------|
| 1639063  | 25        |

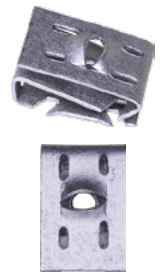



Manufactured to meet or exceed original equipment specifications.

Photos Actual Size

## Fender Apron and Under Cover Torx® Round Washer Head Tapping Screw

- Audi A3 2006-2020, A4, S4 2011-2020, A5, S5 2010-2020, A6 2012-2020, Allroad 2013-2016, Q3, S3 2015-2020, Q5, TTS Quattro 2009-2020, Q7, e-tron Quattro, Q8, RS5 Sportback 2017-2020, R8 2008-2015, RS5 2013-2015, RS7 2014-2018, S6, S7 2013-2020, S8, SQ7, SQ8, 2020, SQ5 2014-2020, TT 2008-2020
- VW Arteon 2019-2021, Atlas 2018-2022, Beetle 2016-2019, CC 2009-2017, e-Golf 2015-2019, Eos 2012-2016, Golf, GTI, 2010-2021, ID.4, 2021-2022, Jetta 2015-2021, Passat 2008-2021, Tiguan 2009-2022, Touareg 2011-2017
- Audi and VW OEM No. N-909-747-01
- M5-2.12 x 16mm
- T-25 Torx® Drive
- 14mm Washer Dia.
- Black Zinc



| Item No. | Pkg. Qty. |
|----------|-----------|
| 1639064  | 25        |

## Hood Latch Mounting Torx® Round Undercut Washer Head Tri-Lobular Thread Bolt

- Audi Q3 2015-2018
- VW Atlas 2018-2022, Beetle 2012-2019, e-Golf 2015-2019, Golf, GTI, Jetta 2010-2021, ID.4 2021-2022, Passat 2012-2021, Tiguan 2009-2022
- Audi and VW OEM No. WHT-000-425
- M6-1.0 x 32mm
- 17mm Washer Outer Dia.
- T-30 Torx® Drive
- Dog Point Type
- Black Zinc

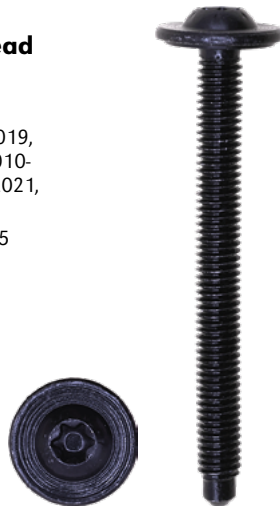

| Item No. | Pkg. Qty. |
|----------|-----------|
| 1639066  | 25        |

## Undercar Heat Shield Retainer

- Audi TT, TTS 2016-2020
- VW Jetta 2019-2022, Passat 2018-2022, Taos 2022+, Tiguan 2018+
- Audi and VW OEM No. WHT-003-386
- 33mm Overall Dia.
- 7mm Overall Height
- Black Nylon



| Item No. | Pkg. Qty. |
|----------|-----------|
| 1639072  | 50        |

## Belt Moulding Clip

- Audi A6, A7 Quattro 2012-2020, A8 Quattro, e-tron Quattro, Q8, RS5 Sportback 2019-2020, Allroad 2013-2016, Q3 2015-2018, Q5 2009-2020, Q7 2017-2020, R8 2014-2015, RS5 2013-2015, RS7 2014-2018, S4 2010-2016, S6, S7 2013-2020, S8, SQ7, SQ8 2020, SQ5 2014-2020, TT 2008-2015
- VW Arteon 2019-2021, Passat 2012-2021, Touareg 2011-2017
- Audi and VW OEM No. 8T0-853-107
- 12mm Width
- 14.5mm Length
- 10mm 'U' Width
- Zinc



| Item No. | Pkg. Qty. |
|----------|-----------|
| 1639059  | 25        |

## Door and Dash Panel Clip

- Audi A3 2006-2020, A4, Q5, TTS Quattro 2009-2020, A5, S5, TT Quattro 2008-2020, A6 2005-2020, A7 Quattro 2012-2020, A8 Quattro 2004-2020, Allroad 2013-2016, e-tron Quattro, Q8, RS5 Sportback 2019-2020, Q3, S3 2015-2020, Q7, S6, S8 2007-2020, R8 2008-2015, RS5 2013-2015, RS7 2014-2018, S4 2010-2020, S7 2013-2020, SQ5 2014-2020, SQ7, SQ8 2020, TT 2008-2009
- VW Arteon 2019-2021, Golf 2010-2021, GTI 2006-2021, Jetta 2011-2018, R32 2008, Rabbit 2006-2009, Tiguan 2009-2018
- Audi and VW OEM No. 1J0-858-137-B
- 10mm Width
- 16mm Length
- 12.5mm 'U' Width
- Zinc



| Item No. | Pkg. Qty. |
|----------|-----------|
| 1639057  | 25        |

## Pillar Trim Panel Clip

- Audi A3, Q5, SQ5 2018-2020, A4 2002-2020, A5, S5 2008-2020, A6, A7 Quattro, A8 Quattro, e-tron Quattro, Q8 2019-2020, Q3 2015-2018, Q7 2017-2020, RS4 2008, RS5 2019-2020, 2013-2015, S3 2015-2020, S4 2004-2020, S6, S7, S8, SQ7, SQ8 2020
- VW Arteon 2019-2021, Atlas 2018-2022, Beetle 2012-2019, CC 2009-2017, e-Golf 2015-2019, Eos 2007-2016, Golf 2010-2021, GTI, Passat 2006-2021, Jetta 2005-2021, Phaeton 2004-2006, R32 2008, Rabbit 2006-2009, Tiguan 2009-2022, Touareg 2012-2017
- Audi and VW OEM No. 4A0-867-276-B
- 9mm Width
- 14mm Length
- 8.5mm 'U' Width
- Zinc



| Item No. | Pkg. Qty. |
|----------|-----------|
| 1639058  | 25        |



# AUDI/VOLKSWAGEN/VOLVO/BMW



Manufactured to meet or exceed original equipment specifications.

Photos Actual Size

## Interior Trim Torx® Round Washer Head Tapping Screw

- Audi A5 Quattro, Q5, S5, SQ5, TT RS Quattro 2018-2020, A6 2012-2018, A7 Quattro, e-tron Quattro, Q3, RS5 Sportback 2019-2020, Q7 2007-2015, S6 2013-2020, S7 2020, TT 2008-2009, TTS Quattro 2009-2020
- VW Arteon 2019-2021, Atlas 2018-2022, Beetle 1998-2019, CC 2009-2017, Eos 2007-2016, Golf 2012-2021, GTI 2006-2021, ID.4 2021-2022, Jetta 2005-2021, Passat 2004-2021, R32 2008, Rabbit 2006-2009, Tiguan 2017-2022, Touareg 2007-2017
- Audi and VW OEM No. N-906-986-06
- M4.2-1.41 x 16mm
- T-20 Torx® Drive
- 12mm Washer Dia.
- Black Zinc



| Item No. | Pkg. Qty. |
|----------|-----------|
| 1639061  | 25        |

## Bumper Screw Grommet

- BMW 318i 1992-1998, 318is 1992-1999, 318ti, 323i, 323is, 328i, 328is, M3 1995-1999, 320i 1993-1995, 325i 1992-1995, 325is 1991-1995
- BMW OEM No. 51-11-2-252-200
- M5 Screw Size
- 9mm x 19mm Head Size
- 21mm Stem Length
- 22mm Overall Height
- Fits into 9mm x 15mm Hole
- White Nylon



| Item No. | Pkg. Qty. |
|----------|-----------|
| 1639073  | 25        |

## Interior Door Trim Panel Clip

- Volvo C30 2007-2013, C70 2008-2013, S40 2004-2012, S60 2011-2020, S90 2017+, V50 2004-2012, V60 2014+, V90 2017-2021, XC60 2009+, XC90 2009+
- Volvo OEM No. 30648194
- 13mm Top Head Dia.
- 4.5mm x 6.5mm Stem Dia.
- 9.5mm Stem Length
- 11mm Overall Length
- Fits into 5mm Hole
- Black Nylon



| Item No. | Pkg. Qty. |
|----------|-----------|
| 1639077  | 25        |